

HIRA ALU FLUID POWER



Datasheet

INDEX

Type and output overview.....	2
Description.....	3
Intelligent thermostat.....	4
Illustration.....	5
Dimensions.....	5
Installation.....	6

TYPE AND OUTPUT

Length mm	Height	Output	Colour	Article Number
440 mm	580 mm	700 Watt	White	384015800440
520 mm	580 mm	1.000 Watt	White	384015800520
760 mm	580 mm	1.500 Watt	White	384015800760
920 mm	580 mm	1.800 Watt	White	384015800920
440 mm	580 mm	700 Watt	Dark Grey	384025800440
520 mm	580 mm	1.000 Watt	Dark Grey	384025800520
760 mm	580 mm	1.500 Watt	Dark Grey	384025800760
920 mm	580 mm	1.800 Watt	Dark Grey	384025800920

DESCRIPTION

The Hudevad Hira Alu Fluid Power is an oil filled radiator made with slimline and compact vertical flat, double aspect tubes. It heats up by using an electrical element immersed in oil within the radiator. This maintenance free and specially formulated fluid is designed to distribute the heat quickly and evenly across the radiator, which in turn emits the heat into your room through radiation. This aluminium radiator has a high heat transfer and a low surface temperature and is practical, user-friendly and ensures the maximum flexibility in terms of use and is an excellent solution when different areas of the house have different temperature needs.

Material	Aluminium - Electric horizontal radiator
Included	Prefilled with oil, thermostat, brackets, manual and remote control. Cable (white or black) 1200 mm, with EU plug Cable, (white or black) 900 mm without plug Please always adhere to local regulations and install the product accordingly.
Technical data	Voltage 230V AC ~50Hz, IP24, Class II
Output	Length: 440 mm: 700 W, 520 mm: 1.000 W, 760 mm: 1.500 W, 920 mm: 1.800 W
Surface treatment	Powder coated in accordance with DIN 55900, EN 442.
Height	580 mm
Length	440, 520, 760 and 920 mm
Depth	90 mm
Installation	This radiator must be wall mounted and must not be installed immediately below or in front of a power socket or directly touch the wall or floor. If installed within a bathroom, the radiator must be mounted outside areas directly affected by water (UK: Zone 1) and the switch / electric control must be in a dry area (UK: Zone 3).
Operation	Control via an integrated thermostat with automatic weekly programming, open window detection, presence detection and boost function. Is also supplied with an infrared remote control. The unit is installed with a Pilot Wire - The home must be fitted with an automation system supporting this type of technology to use.
Warranty	10 years for the radiator and 2 years for the electrical components, as long as the Hudevad installation instructions have been followed, the warranty conditions have been met and the radiator is installed outside the splash area.

INTELLIGENT THERMOSTAT



The digital control for the Hudevad Hira Alu is with an LCD display and is located on the top right hand side of the radiator, with several functions for efficiency, energy saving and safety in mind.

Temperature setting	Adjustable from + 7 °C to + 32 °C
Possible operating modes	Standby, Comfort, Night/Eco, Anti-Freeze, Chrono
7-day/week program	Possible
Boost/Overdrive	Can be used to heat the room quickly. The appliance heats at the maximum power for 2 hours, independently from the temperature setting.
Open window detection	Automatic switches to Anti-Freeze setting when a significant temperature drop is detected.
Child safety/key pad lock	The control panel can be locked.
Ergonomic	Backlit display, adjustment is simple and intuitive.
More information	<p>The appliance is designed to heat rooms. When operating the surface of the appliance can become hot and may cause burns. Avoid contact with parts of the body. Pay particular attention when children are present.</p> <p>More information, instructions and how to install can be found in the Hira Alu Fluid Power manual.</p>

ILLUSTRATIONS

Drawing 5.1

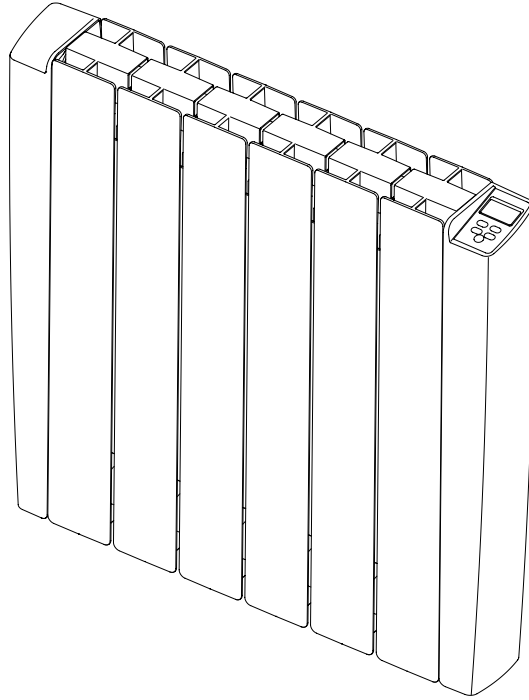

DIMENSIONS

Drawing 5.2

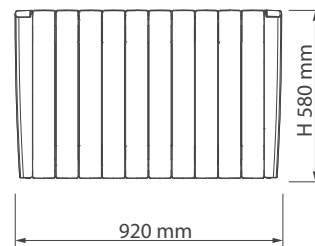
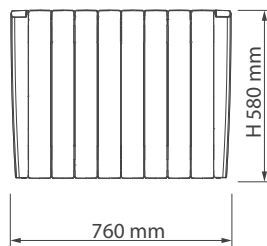
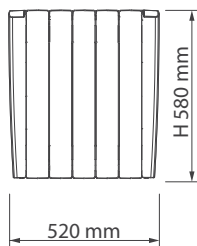
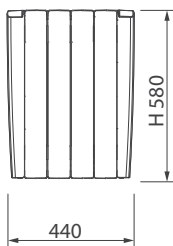

HUDEVAD
RADIATOR DESIGN

INSTALLATION

Power (W)	No. of elements	Number of brackets - TOP	Number of brackets - BOTTOM	X mm
700	4	2	1	161
1.000	5	2	1	242
1.500	8	2	1	482
1.800	10	2	1	643

Drawing 6.1

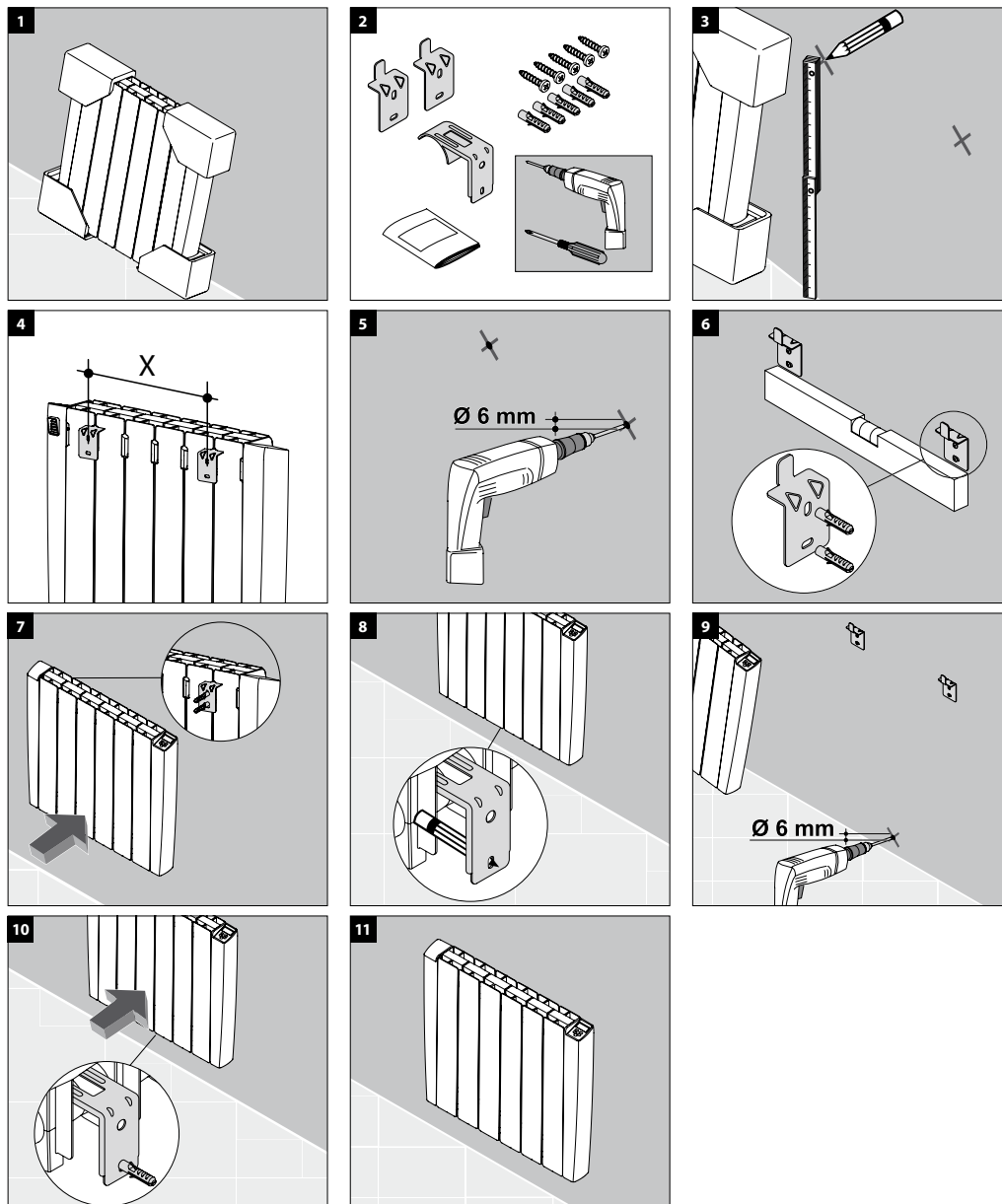

Please allow min. 150 mm air below and to either side and at least 600 mm above and to items placed in the area such as furniture, curtains etc. For further information on installation, brackets, etc. please see the Hudevad Hira Alu Fluid Power manual.

HUDEVAD
RADIATOR DESIGN