

LK



Datasheet

INDEX

Specification..... 2
 Description..... 3
 Tapping overview..... 4
 Illustrations..... 4
 Dimensions..... 4
 Installation options..... 6
 Forced water / serial connection..... 7
 Output..... 8
 Accessories..... 8
 Availability Matrix..... 9

SPECIFICATION

HOW TO SPECIFY AN ITEM

Item number example 151012210

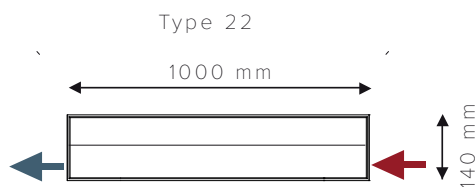
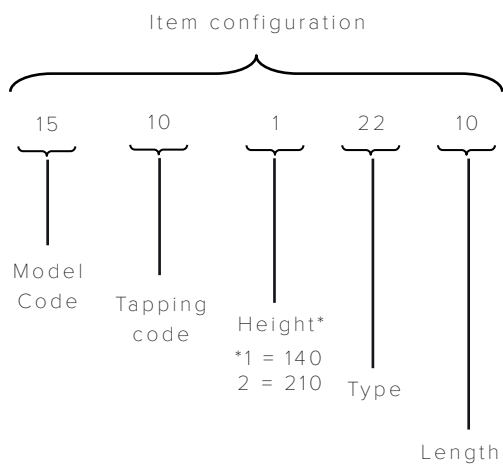

Note

Thermostat sensor head is not included in the product - should be ordered separately.

DESCRIPTION

Hudevad LK is a low convector radiator made of profiled steel tubes. The radiator has a flat, sleek design on both the rear and front side, making it ideal for use in front of glazing. Hudevad LK is available in two heights. It is suitable for installation on the wall, floor, in a convector trench, under bench seating, or under the ceiling.

Material	Panels: Profiled steel tubes 70 x 11 x 2 mm, EN 10130 Convectors: 0.5 mm steel plates EN 10051, EN 10130, DIN 2395
Test pressure	13 bar
Max. operating pressure	10 bar - in accordance with EN 442
Max. operating temperature	95°C
Warranty	10 years
Surface treatment	Pre-treatment by degreasing and steel phosphating. Powder coated in accordance with DIN 55900, EN 442.
Type	22 (2-20 and 3-20) and 34 (2-30 and 3-30)
Height	140 and 210 mm For 70 mm height please see Hudevad Piso
Length	Type 22: 600 - 3000 mm Type 34: 600 - 3000 mm
Depth	Type 22: 84 mm and Type 34: 157 mm
Connections	All tappings 1/2" standard (adapters available)
Installation	Wall or floor mounted.
Mounting straps	No mounting straps
Colour	Powder coated in white RAL 9016, gloss 70 Option: Painted in other colours. Please see the Hudevad Radiator Design Colour Brochure at www.hudevad.com
Options	Feet, shelf brackets and forced water.

TAPPING OVERVIEW

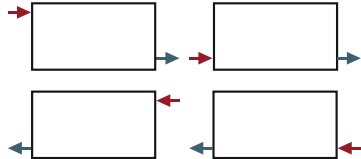
Tapping code	Tapping type	Tapping possibilities
10	ABCD (4 tap)	

ILLUSTRATIONS

VIEW FROM THE FRONT

Drawing 4.1

Type 22

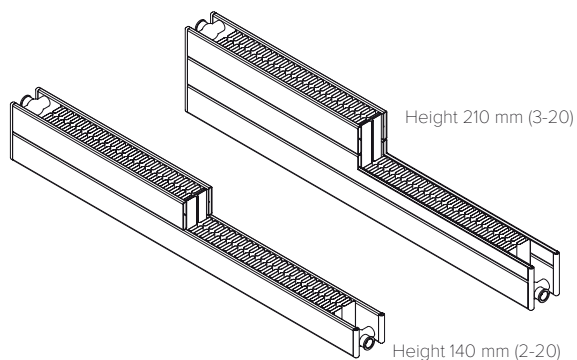

Type 34

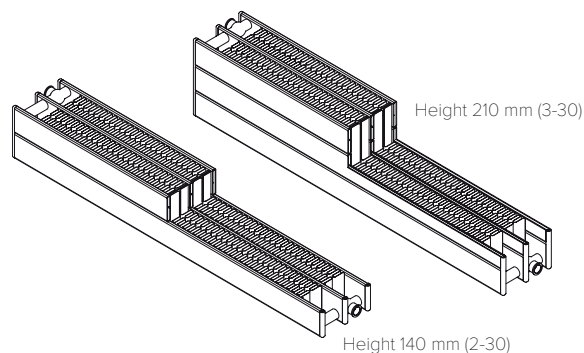

DIMENSIONS

Drawing 4.2

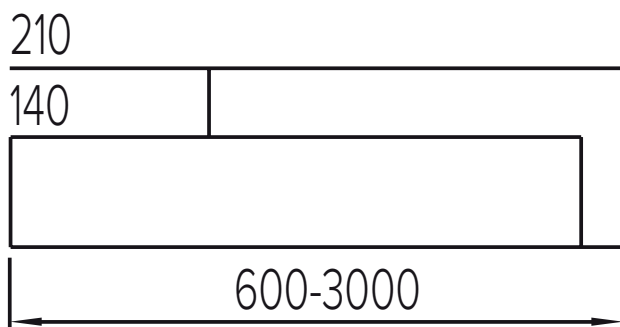

DEPTH

Type 22

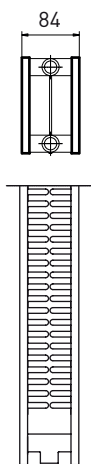

Type 34

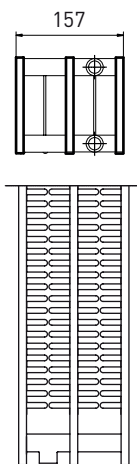

Drawing 5.1

BUILD-IN DIMENSIONS

Type 22

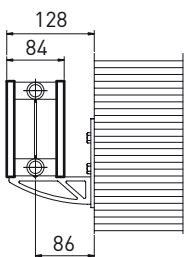

Type 34

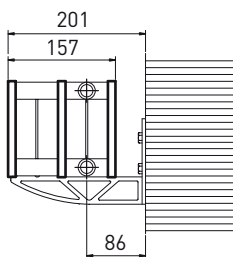

Drawing 5.2

2 brackets or feet up to 2000 mm
3 brackets or feet from 2000 mm - 3000 mm

MOUNTING BRACKET DIMENSION

Type 22

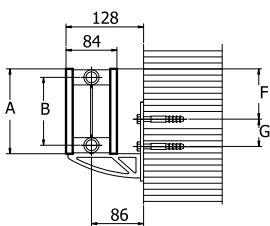

Type 34

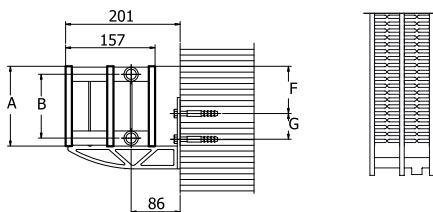

Drawing 5.3

Measurement diagram

LK type	Type 22/34	Type 22/34
A (height)	140	210
B (center distance)	108	178
F	83+10	153+10
G	45	45

2 brackets or feet up to 2000 mm
3 brackets or feet from 2000 mm - 3000 mm

INSTALLATION OPTIONS

MOUNTED IN CEILING

When mounting on ceiling, additional 10°C air and room temperature is used in calculation, which means Δt is 10°C lower than a corresponding floor mounting.

MOUNTED IN TRENCH

When mounting in trench, the table value for the output is reduced by approximately 20%, and to ensure the air circulation conductor plates are attached from the convector side to the under-edge of the grille. By doing that there is a division between the hot rising air and the cold descending air.

In trench: Heating of cold window zone and the remaining room

Fig. 1

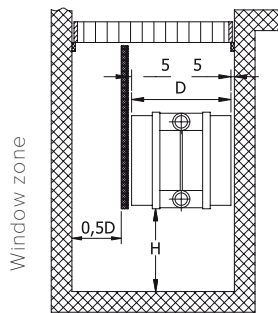

In trench: Heating of cold window zone and the remaining room

Fig. 2

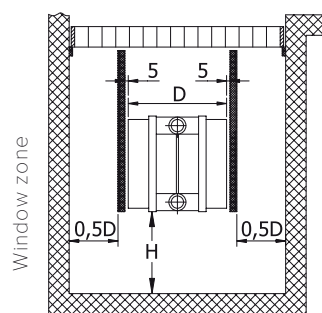

Underneath ceiling: Heating of cold window zone and the remaining room

Fig. 3

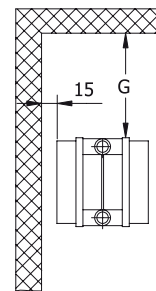

Drawing 6.1

LK type	G-measurement min. (mm)	H-measurement min. (mm)	Trench depth min. (mm)	Trench width min. (mm)	Trench width min. (mm)
Type 22	100	120	280	145 Fig. 1	196 Fig. 2
Type 34	125	120	280	253	340

FORCED WATER

SERIAL CONNECTION

Hudevad LK can be installed in serial connection using forced water. At the factory, rubber plugs are installed inside the radiator that directs the water in the right direction, so that the hot water is led out into the front panels and returns in the rear panels. Hudevad's serial connection can be used on all radiators or convectors with 4 connections (ABCD), but NOT on valve radiators. The system can be used on all radiators or convectors with 2 panels or more.

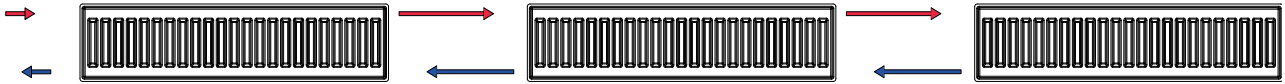

HOW IT WORKS

Drawing 71

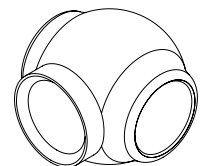
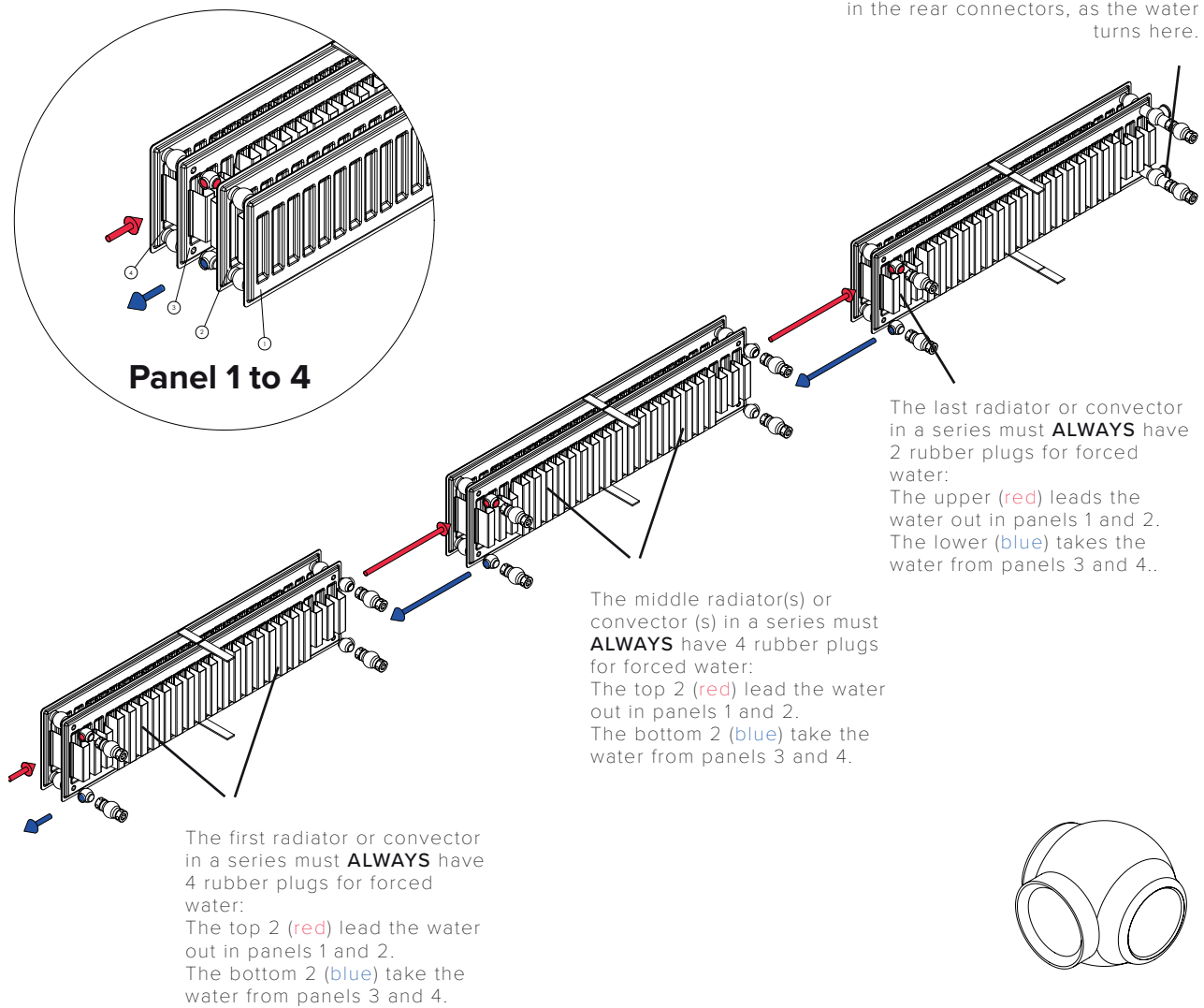

61610035 1 pc.
61610037 Mounting, 2 pcs./radiator
61610038 Mounting, 4 pcs./radiator

OUTPUT

TAPPING CODE 10

LK TYPE 22

Height, mm	Output			Water content	Weight
	W/metre 75°/65°/20°	W/metre 70°/40°/20°	W/metre 60°/30°/20°	litres/ metre	kg/ metre
140	594	357	216	1.80	13.5
210	757	440	258	2.60	20.4

LK TYPE 34

Height, mm	Output			Water content	Weight
	W/metre 75°/65°/20°	W/metre 70°/40°/20°	W/metre 60°/30°/20°	litres/ metre	kg/ metre
140	1021	598	353	2.8	24.8
210	1314	764	448	4.0	33.0

ACCESSORIES

LK FEET

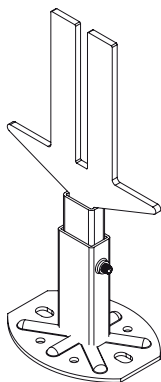

30204310, Low, Narrow, type 22
30204315 Low, Wide, type 34
30204320, High, Narrow, type 22
30204325 High, Wide, type 34

BRACKET

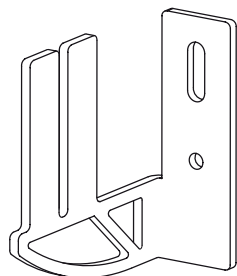

30204022 Narrow, type 22
30204020 Wide, type 34

SHELF BRACKET

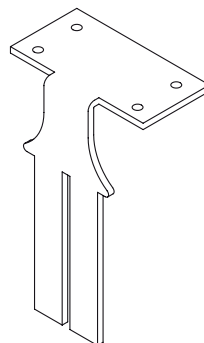

30204063 Narrow, type 22
30204064 Wide, type 34

FORCED WATER

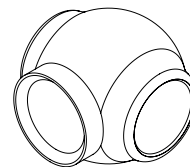

61610035 1 pc.
61610037 Mounting, 2 pcs./radiator
61610038 Mounting, 4 pcs./radiator

DANFOSS ACCESSORIES

Drawing 8.1

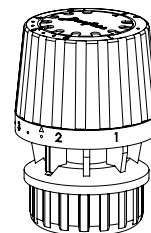
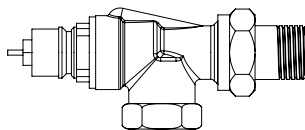
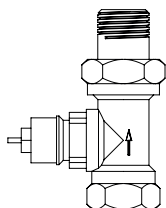

Hudevad recommends use of Danfoss accessories when fitting the radiator.
For further accessories please refer to the Hudevad Pricelist.

AVAILABILITY MATRIX

TAPPINGCODE 10 - ABCD

H 140 mm

H 210 mm

Lgth./Type	H 140 mm		H 210 mm	
	22	34	22	34
600	●	●	●	●
800	●	●	●	●
1000	●	●	●	●
1200	●	●	●	●
1400	●	●	●	●
1500	●	●	●	●
1600	●	●	●	●
1800	●	●	●	●
2000	●	●	●	●
2200	●	●	●	●
2400	●	●	●	●
2600	●	●	●	●
2800	●	●	●	●
3000	●	●	●	●