

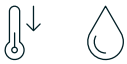

PIANO VERTICAL

12 elements, height 1820 mm, length 680 mm. Ivory finish (cod. 02). Configuration cod. 80.



Technical features:

- manifolds with a 30 mm diameter circular section
- tubes made of sheet steel with a 50x10 mm rectangular section
- manifold threading 1/2" Gas right
- maximum working pressure 4 bar
- maximum working temperature 95°C

Price included:



Finishes available Surcharge

- Standard White
- Classic finishes
- Special finishes
- Other RAL colors

Finishing codes see page 596.

Number of elements:

Radiators with an odd number of elements will be supplied at the same price as a radiator with the next even number of elements.
For example: a PIANO Vertical 1820 high and 9 elements wide = the price of a PIANO Vertical 1820 high and 10 elements wide



Model	Code	Depth mm	Height H mm	Conn. centre H' mm	Weight Kg	Capacity lt	Thermal Power				Exponent n.	
							$\Delta t=50^{\circ}\text{C}$ Btu/h	$\Delta t=50^{\circ}\text{C}$ Watt	$\Delta t=40^{\circ}\text{C}$ Watt	$\Delta t=30^{\circ}\text{C}$ Watt (*)		$\Delta t=20^{\circ}\text{C}$ Watt
520	PI1 0520 YY 01 A4 01 A	38	520	470	0,64	0,25	116,3	34,1	25,6	17,7	10,6	1,280
700	PI1 0700 YY 01 A4 01 A	38	700	650	0,82	0,31	152,7	44,8	33,5	23,1	13,7	1,295
920	PI1 0920 YY 01 A4 01 A	38	920	870	1,04	0,39	195,3	57,2	42,7	29,2	17,2	1,314
1220	PI1 1220 YY 01 A4 01 A	38	1220	1170	1,39	0,48	255,9	75,0	56,0	38,4	22,6	1,310
1520	PI1 1520 YY 01 A4 01 A	38	1520	1470	1,64	0,60	315,3	92,4	69,0	47,4	27,9	1,306
1820	PI1 1820 YY 01 A4 01 A	38	1820	1770	1,94	0,70	375,0	109,9	82,2	56,5	33,3	1,302
2020	PI1 2020 YY 01 A4 01 A	38	2020	1970	2,14	0,77	415,0	121,6	91,0	62,6	37,0	1,300
2220	PI1 2220 YY 01 A4 01 A	38	2220	2170	2,39	0,83	455,3	133,4	99,9	68,8	40,7	1,297
2520	PI1 2520 YY 01 A4 01 A	38	2520	2470	2,64	0,94	516,4	151,3	113,4	78,2	46,3	1,293

(*) Thanks to the high performance of Irsap PIANO Vertical radiators, the ideal Δt for low temperature projects is Δt at 30°C.

For Δt different from 50°C use the formula: $Q=Q_n (\Delta t / 50)^n$

Special Options

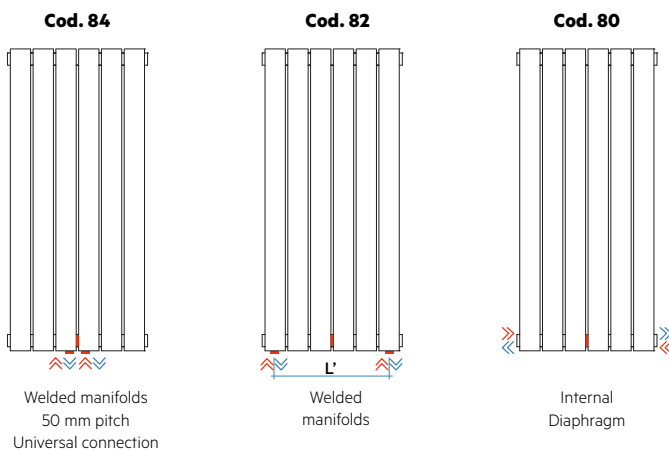

Manifolds:

The pipefittings welded on the bottom manifold can be positioned at any point at a specified distance between centres. It is compulsory in this type of installation to install a diaphragm during production to ensure the product functions correctly. The minimum possible distance between centres is equal to 50 mm (cod. 84), while the maximum distance depends on the length of the radiator (cod. 82).

The maximum distance between centres is equal to the number of elements - 1 multiplied by 56 (element pitch): $L' = 56 \times (n^{\circ} \text{ of elements } - 1)$.

Bottom Connections (Cod. M82, M84): For bottom water connections insert an internal flow diverter to the bottom manifold

Internal Diaphragm (Cod. M80): Prearrangement for bottom connections with 1/2" welded fittings and internal baffle

Configured for connection with single-pipe valve: connection available only for modul and/or double-pipe systems, no monotube valve with loop - (specify water inlet)

For other connections see page 172

Connection dimensions with IRSAP valves

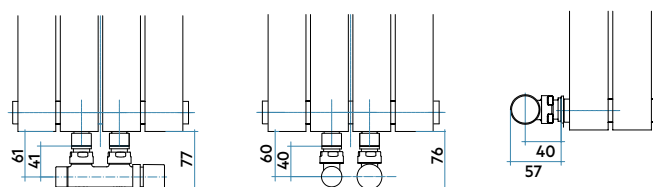

Key Codes

Height | Number of elements | Packing code | Standard hydraulic code connection. For other connections, see pag. 172

PI1 0520 YY 01 A4 01 A — Vertical

Standard White color code.

For different color codes see the colors page.

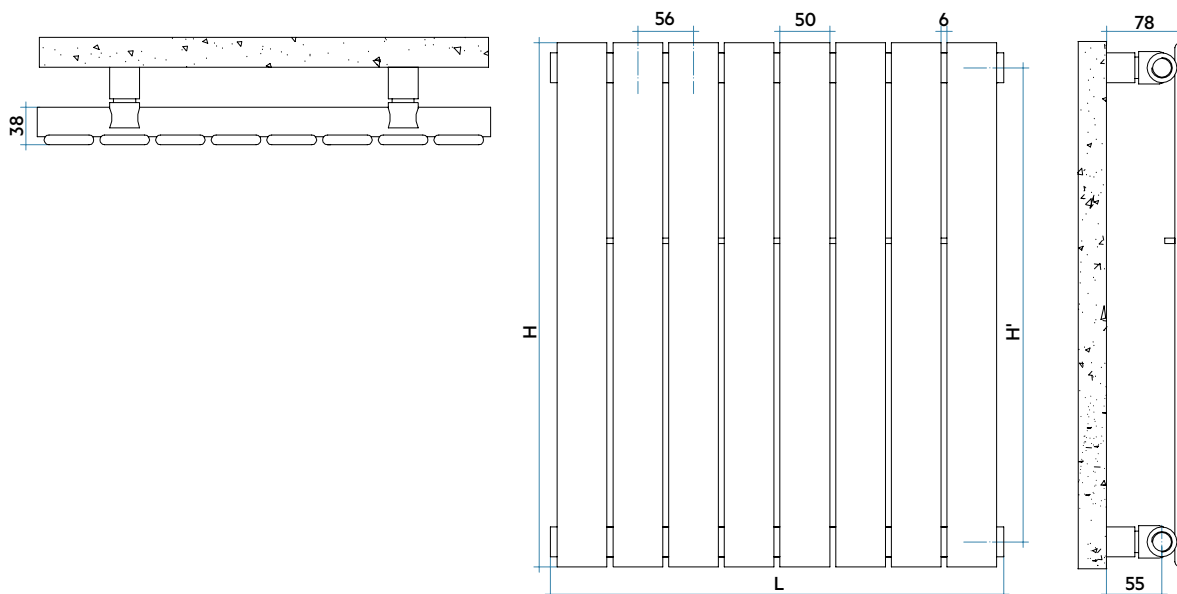

PIANO

COMPLETE BATTERY DATA

(L)	HEIGHT (H)									
	520	700	920	1220	1520	1820	2020	2220	2520	
Lenght mm 232 <i>yy = N° elem.</i> 4	W	136	179	229	300	370	440	487	534	605
Lenght mm 344 <i>yy = N° elem.</i> 6	W	205	269	343	450	554	659	730	801	908
Lenght mm 456 <i>yy = N° elem.</i> 8	W	273	358	458	600	739	879	973	1068	1211
Lenght mm 568 <i>yy = N° elem.</i> 10	W	341	448	572	750	924	1099	1216	1335	1514
Lenght mm 680 <i>yy = N° elem.</i> 12	W	409	537	687	900	1109	1319	1460	1601	1816
Lenght mm 792 <i>yy = N° elem.</i> 14	W	477	627	801	1050	1294	1539	1703	1868	2119
Lenght mm 904 <i>yy = N° elem.</i> 16	W	545	716	916	1200	1479	1758	1946	2135	2422
Lenght mm 1016 <i>yy = N° elem.</i> 18	W	614	806	1030	1350	1663	1978	2189	2402	2724
Lenght mm 1128 <i>yy = N° elem.</i> 20	W	682	895	1145	1500	1848	2198	2433	2669	3027
Lenght mm 1240 <i>yy = N° elem.</i> 22	W	750	985	1259	1650	2033	2418	2676	2936	3330
Lenght mm 1352 <i>yy = N° elem.</i> 24	W	818	1074	1374	1800	2218	2638	2919	3203	
Lenght mm 1464 <i>yy = N° elem.</i> 26	W	886	1164	1488	1950	2403	2857	3162		
Lenght mm 1576 <i>yy = N° elem.</i> 28	W	955	1253	1602	2100	2587	3077			
Lenght mm 1688 <i>yy = N° elem.</i> 30	W	1023	1343	1717	2250	2772	3297			

Decorative & Technical Accessories

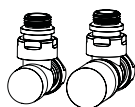

Kit Valves and
Lockshield valve
Pag. 562

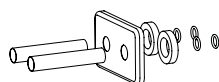

Pipe cover kit
Pag. 566

