

GRATA

GRATA is a radiator of sought-after design and high thermal output, similar to the Form radiators.

These characteristics make the GRATA extremely useful when a very decorative effect is needed: its versatility, with the addition of special feet and clamps, allows

it also to be used as a room partition, parapet or staircase handrail. GRATA is made using steel radiating pipes of $\varnothing 12$ mm positioned with a distance between the centres of the tubes of 30 mm. The thin steel gills between the radiating tubes notably increase the thermal output.

The two models produced are GRH which have horizontal manifolds and vertical radiating tubes, and GRV which have vertical manifolds and horizontal radiating pipes. These two models can have radiating tubes up to 300 cm in length.

MODEL GRH

with vertical radiating tubes

H = from 60 to 300 cm (every 20 cm)
Height on request every 5 cm

L = from 20 to 110 cm (every 6 cm)
Width on request every 3 cm

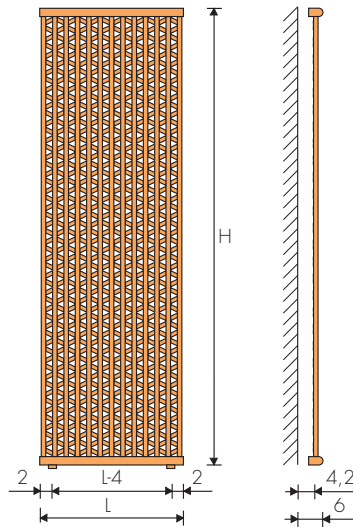

TAPPING CENTRES GRH MODEL

EG Vertical fittings
▲▽ t.c. = L - 4 cm

Side fittings
▲▽ t.c. = H - 2,2 cm

* Coupling protrudes 1 cm

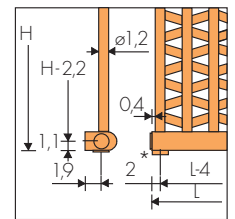

CD Fitting:

▲▽ t.c. = L + 8,4 cm with Brem valves



STANDARD FITTING EG $\varnothing 1/2"$

▲▽ t.c. = L - 4 cm

MODEL GRV

with horizontal radiating tubes

H = from 20 to 116 cm (every 6 cm)
Height on request every 3 cm

L = from 60 to 300 cm (every 20 cm)
Length on request every 5 cm

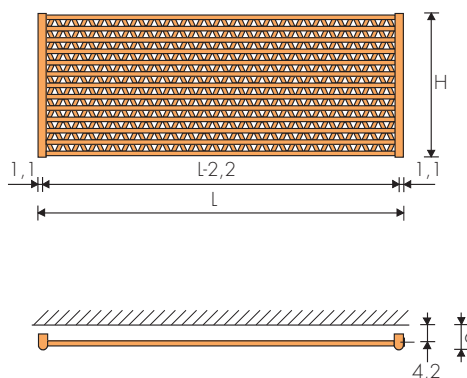

TAPPING CENTRES GRV MODEL

EG Vertical fittings
▲▽ t.c. = L - 2,2 cm

Side fittings
▲▽ t.c. = H - 4 cm

* Coupling protrudes 1 cm

Reverse fitting:
(H + 6 cm) Art. REG 70,40€
▲▽ t.c. = L - 15 cm (Brem valves)

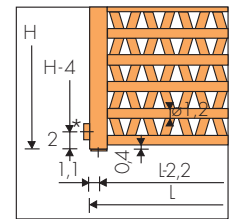

STANDARD FITTING

EG $\varnothing 1/2"$ ▲▽ = L - 2,2 cm



HOW TO ORDER

State: model, height and width in cm; connection and color if different from standard.
eg.: GRH 180 - 38, AC $\varnothing 3/8"$, SB 2008

STANDARD PRODUCTION

White "sablé" paintwork - white M4G brackets
Tolerance ± 3 mm - Air vent $\varnothing 1/8"$
Maximum working pressure: 8 Bar

PRODUCTION ON REQUEST

Brem color chart painting with chrome-plated brackets
+15/25%
Fittings on request
page 292

GRATA

GRATA GRH (vertical tubes)

EN 442 Watt Δt 50 K

MOD.	Lengths/Longueurs																
H cm	L cm	20	26	32	38	44	50	56	62	68	74	80	86	92	98	104	110
GRH 60	€	425,90 146w	478,90 190w	523,50 234w	565,70 278w	609,40 322w	660,90 366w	721,80 410w	824,90 454w	911,20 498w	1001,5 542w	1084,2 586w	1169,4 630w	1256,9 673w	1340,3 717w	1438,3 761w	1522,1 805w
GRH 80	€	451,10 187w	507,70 243w	552,80 299w	600,00 355w	643,00 411w	699,20 468w	740,30 524w	873,00 580w	959,50 636w	1047,9 692w	1134,1 748w	1221,4 804w	1293,3 860w	1396,4 916w	1488,9 972w	1567,2 1029w
GRH 100	€	462,70 229w	523,50 297w	572,50 366w	618,70 435w	664,70 503w	719,60 572w	812,10 641w	901,30 709w	988,10 778w	1078,4 847w	1171,3 915w	1259,7 984w	1348,1 1052w	1438,3 1121w	1527,0 1190w	1605,4 1258w
GRH 120	€	491,70 268w	557,80 348w	608,80 429w	658,60 509w	706,90 590w	765,70 670w	861,10 750w	954,40 831w	1052,4 911w	1147,8 992w	1243,2 1072w	1338,4 1152w	1433,7 1233w	1528,8 1313w	1623,9 1394w	1719,1 1474w
GRH 140	€	530,10 308w	600,00 400w	654,00 492w	706,90 585w	760,70 677w	822,80 770w	924,10 862w	1027,0 954w	1128,3 1047w	1230,2 1139w	1334,5 1231w	1436,7 1324w	1541,2 1416w	1643,8 1508w	1744,7 1601w	1850,0 1693w
GRH 160	€	596,30 346w	673,60 449w	734,40 553w	792,20 657w	853,20 760w	924,10 864w	1037,0 968w	1152,7 1071w	1266,4 1175w	1379,5 1279w	1497,6 1382w	1615,3 1486w	1730,3 1590w	1841,8 1693w	1959,0 1797w	2074,9 1901w
GRH 180	€	658,60 383w	743,20 497w	809,90 612w	878,60 727w	944,50 842w	1023,3 957w	1149,9 1071w	1277,5 1186w	1403,0 1301w	1530,9 1416w	1660,3 1530w	1787,1 1645w	1915,8 1760w	2042,1 1875w	2166,9 1990w	2296,6 2104w
GRH 190	€	688,40 404w	779,90 525w	848,30 647w	920,00 758w	988,60 889w	1071,5 1011w	1202,5 1132w	1337,4 1253w	1468,9 1374w	1603,5 1496w	1739,0 1617w	1871,6 1738w	2006,0 1859w	2137,4 1981w	2271,0 2102w	2405,8 2223w
GRH 200	€	719,60 419w	815,00 545w	887,50 671w	962,20 796w	1034,0 922w	1119,2 1048w	1257,9 1174w	1397,0 1300w	1534,8 1425w	1675,3 1551w	1817,5 1677w	1956,9 1803w	2096,2 1928w	2231,2 2054w	2375,3 2180w	2513,6 2306w
GRH 210	€	748,00 429w	847,20 557w	924,10 686w	1000,8 815w	1075,2 943w	1165,6 1072w	1310,1 1201w	1455,4 1329w	1598,5 1458w	1744,7 1587w	1890,9 1715w	2036,3 1844w	2182,9 1972w	2324,2 2101w	2472,4 2230w	2617,0 2358w
GRH 220	€	779,00 453w	881,70 589w	959,50 724w	1038,6 860w	1117,3 996w	1210,7 1132w	1360,7 1268w	1512,3 1404w	1660,3 1540w	1812,7 1675w	1963,7 1811w	2116,2 1947w	2267,3 2083w	2416,5 2219w	2568,8 2355w	2719,9 2490w
GRH 240	€	836,90 486w	946,80 632w	1031,0 777w	1115,4 923w	1201,0 1069w	1299,9 1215w	1460,3 1360w	1620,2 1506w	1781,2 1652w	1944,2 1797w	2108,0 1943w	2267,3 2089w	2432,1 2235w	2593,6 2380w	2754,1 2526w	2919,3 2672w
GRH 260	€	918,00 517w	1037,0 672w	1130,0 827w	1222,7 982w	1315,7 1137w	1425,0 1293w	1596,7 1448w	1773,2 1603w	1950,0 1758w	2171,1 1913w	2307,4 2068w	2486,3 2223w	2661,0 2378w	2838,5 2533w	3016,7 2688w	3196,5 2844w
GRH 280	€	997,50 548w	1128,3 712w	1228,3 877w	1331,3 1041w	1430,5 1206w	1548,3 1370w	1740,9 1534w	1930,7 1699w	2125,8 1863w	2362,4 2028w	2513,6 2192w	2707,9 2356w	2897,4 2521w	3090,2 2685w	3283,5 2850w	3479,6 3014w
GRH 300	€	1084,2 577w	1225,5 750w	1336,2 923w	1445,4 1096w	1555,6 1269w	1683,1 1443w	1892,9 1616w	2101,3 1789w	2312,4 1962w	2570,0 2135w	2735,6 2308w	2945,7 2481w	3152,9 2654w	3362,9 2827w	3571,3 3000w	3785,0 3174w

Δt different from 50 K: technical data Brem

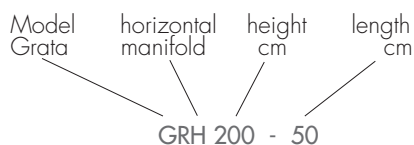

PRODUCTION ON REQUEST

Thermal output and prices can be obtained by interpolation:

- length of manifolds every 3 cm
- height of radiating tubes every 10 cm

Made-to-measure (±3 mm)

Sizes over 3 m: price on request

Height every 5 cm: increased size +15%

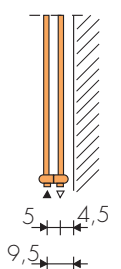
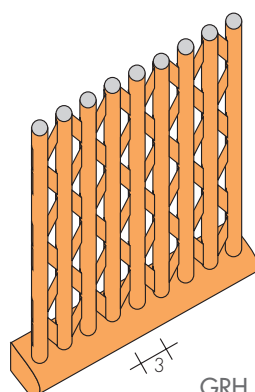

DOUBLE VERSION GDH

Is obtained by joining two GRH radiators
PRICE GDH GRH x 2 + 108,20€

Standard EG fitting (delivery on left, at front; return on right, at rear).

Thermal output GDH: single radiator x 1,60

EN 442 Watt Δt 50 K

MOD.	L cm	Lengths/Longueurs												
		60	80	100	120	140	160	180	200	220	240	260	280	300
GRV 20	€	425,90 131w	451,10 174w	462,70 218w	491,70 262w	530,10 305w	596,30 349w	658,60 392w	719,60 436w	779,00 480w	836,90 523w	918,00 567w	997,50 610w	1084,2 654w
GRV 26	€	478,90 172w	507,70 229w	523,50 286w	557,80 343w	600,00 400w	673,60 458w	743,20 515w	815,00 572w	881,70 629w	946,80 686w	1037,0 744w	1128,3 801w	1225,5 858w
GRV 32	€	523,50 212w	552,80 283w	572,50 354w	608,80 425w	654,00 496w	734,40 566w	809,90 637w	887,50 708w	959,50 779w	1031,0 850w	1130,0 920w	1228,3 991w	1336,2 1062w
GRV 38	€	565,70 254w	600,00 338w	618,70 423w	658,60 508w	706,90 592w	792,20 677w	878,60 761w	962,20 846w	1038,6 931w	1115,4 1015w	1222,7 1100w	1331,3 1184w	1445,4 1269w
GRV 44	€	609,40 295w	643,00 393w	664,70 491w	706,90 589w	760,70 687w	853,20 786w	944,50 884w	1034,0 982w	1117,3 1080w	1201,0 1178w	1315,7 1277w	1430,5 1375w	1555,6 1473w
GRV 50	€	660,90 336w	699,20 448w	719,60 560w	765,70 672w	822,80 784w	924,10 896w	1023,3 1008w	1119,2 1120w	1210,7 1232w	1299,9 1344w	1425,0 1456w	1548,3 1568w	1683,1 1680w
GRV 56	€	721,80 377w	740,30 503w	812,10 629w	861,10 755w	924,10 881w	1037,0 1006w	1149,9 1132w	1257,9 1258w	1360,7 1384w	1460,3 1510w	1596,7 1635w	1740,9 1761w	1892,9 1887w
GRV 62	€	824,90 420w	873,00 560w	901,30 700w	954,40 840w	1027,0 980w	1152,7 1120w	1277,5 1260w	1397,0 1400w	1512,3 1540w	1620,2 1680w	1773,2 1820w	1930,7 1960w	2101,3 2100w
GRV 68	€	911,20 461w	959,50 615w	988,10 769w	1052,4 923w	1128,3 1077w	1266,4 1230w	1403,0 1384w	1534,8 1538w	1660,3 1692w	1781,2 1846w	1950,0 1999w	2125,8 2153w	2312,4 2307w
GRV 74	€	1001,5 503w	1047,9 670w	1078,4 838w	1147,8 1006w	1230,2 1173w	1379,5 1341w	1530,9 1508w	1675,3 1676w	1812,7 1844w	1944,2 2011w	2171,1 2179w	2362,4 2346w	2570,7 2514w
GRV 80	€	1084,2 545w	1134,1 726w	1171,3 908w	1243,2 1090w	1334,5 1271w	1497,6 1453w	1660,3 1634w	1817,5 1816w	1963,7 1998w	2108,0 2179w	2307,4 2361w	2513,6 2542w	2735,6 2724w
GRV 86	€	1169,4 586w	1221,4 782w	1259,7 977w	1338,4 1172w	1436,7 1368w	1615,3 1563w	1787,1 1759w	1956,9 1954w	2116,2 2149w	2267,3 2345w	2486,3 2540w	2707,9 2736w	2945,7 2931w
GRV 92	€	1256,9 628w	1293,3 837w	1348,1 1046w	1433,7 1255w	1541,2 1464w	1730,3 1674w	1915,8 1883w	2096,2 2092w	2267,3 2301w	2432,1 2510w	2661,0 2720w	2897,4 2929w	3152,9 3138w
GRV 98	€	1340,3 669w	1396,4 892w	1438,3 1115w	1528,8 1338w	1643,8 1561w	1841,8 1784w	2042,1 2007w	2231,2 2230w	2416,5 2453w	2593,6 2676w	2838,5 2899w	3090,2 3122w	3362,9 3345w
GRV 104	€	1438,3 710w	1488,9 947w	1527,0 1184w	1623,9 1421w	1744,7 1658w	1959,0 1894w	2166,9 2131w	2375,3 2368w	2568,8 2605w	2754,1 2842w	3016,7 3078w	3283,5 3315w	3571,3 3552w
GRV 110	€	1522,1 752w	1567,2 1002w	1605,4 1253w	1719,1 1504w	1850,0 1754w	2074,9 2005w	2296,6 2255w	2513,6 2506w	2719,9 2757w	2919,3 3007w	3196,5 3258w	3479,6 3508w	3785,0 3759w
GRV 116	€	1607,2 793w	1654,5 1058w	1702,5 1322w	1820,6 1586w	1950,0 1851w	2189,7 2115w	2428,2 2380w	2657,2 2644w	2873,2 2908w	3083,4 3173w	3376,6 3437w	3675,4 3702w	3997,3 3966w

Δt different from 50 K: technical data Brem



PRODUCTION ON REQUEST

Thermal output and prices can be obtained by interpolation:

- height of manifolds every 3 cm
- length of radiating tubes every 10 cm

Made-to-measure (± 3 mm)

Sizes over 3 m: price on request

Height every 5 cm: increased size +15%

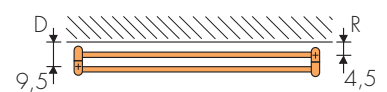
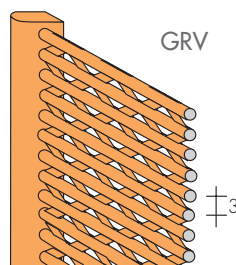

DOUBLE VERSION GDV

Is obtained by joining two GRV radiators
PRICE GDV GRV x 2 + 108,20€

Standard EG fitting (delivery on left, at front; return on right, at rear).

Thermal output GDV: single radiator x 1,65